

GR-ROUND BALL DIAMOND GRINDING PINS

GR Pins are used in jig or internal or hand grinding of carbide, ceramics and hardened steel for pre-formed carbide shapes, ceramics, electronic parts, plastic mold and die cast dies. **Available in 80/100 and 170/200 grit diamond IN STOCK.** CBN is a delayed delivery of 4 to 6 weeks. When ordering CBN add suffix "B" after GR# (Ex. GR1B-C for Borazon 80/100)



Order # for 80/100	Order # for 170/200	Diameter "MM"	Shank Diameter "MM"	Shank Length "MM"
GR1-C	GR1-F	1	3	45
GR2-C	GR2-F	2	3	45
GR3-C	GR3-F	3	3	45
GR4-C	GR4-F	4	3	45
GR5-C	GR5-F	5	3	45
GR6-C	GR6-F	6	3	45
GR7-C	GR7-F	7	6	60
GR8-C	GR8-F	8	6	60
GR9-C	GR9-F	9	6	60
GR10-C	GR10-F	10	6	60
GR11-C	GR11-F	11	6	60
GR12-C	GR12-F	12	6	60

TITAN DIAMOND and CBN RESIN MOUNTED WHEELS

BOND USED IS A SPECIAL RESIN BOND THAT CAN BE TRUED AND GENERATED TO ANY SHAPE NECESSARY. BOTH DIAMOND AND CBN ARE 100 CONCENTRATION.

(Prices are the same for Dimond or CBN or grit listed below please specify grit when ordering. Shanks are High Speed Steel)
14-21 Day Lead Time

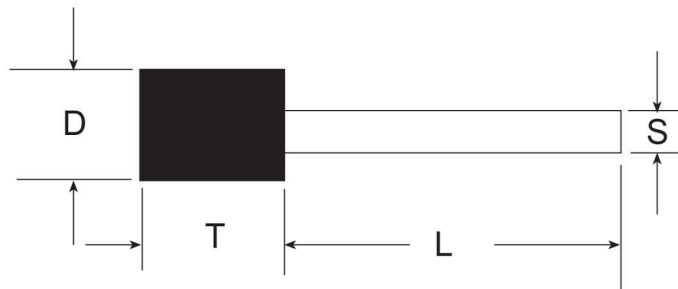

D	T	Y	L	Diamond		CBN	
				Coarse (120)	Medium (180)	Coarse (120)	Medium (220)
0.125"	3/16"	1/8"	2"	DAC-101	DAM-101	CBC-101	CBM-101
0.156"	3/16"	1/8"	2"	DAC-102	DAM-102	CBC-102	CBM-102
0.187"	3/16"	1/8"	2"	DAC-103	DAM-103	CBC-103	CBM-103
0.250"	1/4"	1/4"	2-3/4"	DAC-104	DAM-104	CBC-104	CBM-104
0.312"	1/4"	1/4"	2-3/4"	DAC-105	DAM-105	CBC-105	CBM-105
0.375"	1/4"	1/4"	2-3/4"	DAC-106	DAM-106	CBC-106	CBM-106
0.437"	1/4"	1/4"	2-3/4"	DAC-107	DAM-107	CBC-107	CBM-107
0.500"	1/4"	1/4"	2-3/4"	DAC-108	DAM-108	CBC-108	CBM-108
0.625"	1/4"	3/8"	3-1/2"	DAC-109	DAM-109	CBC-109	CBM-109
0.750"	1/4"	3/8"	3-1/2"	DAC-110	DAM-110	CBC-110	CBM-110
1.000"	1/4"	3/8"	3-1/2"	DAC-111	DAM-111	CBC-111	CBM-111

www.TitanToolSupply.com • Phone: 716-873-9907