

## GR-ROUND BALL DIAMOND GRINDING PINS

GR Pins are used in jig or internal or hand grinding of carbide, ceramics and hardened steel for pre-formed carbide shapes, ceramics, electronic parts, plastic mold and die cast dies. **Available in 80/100 and 170/200 grit diamond IN STOCK.** CBN is a delayed delivery of 4 to 6 weeks. When ordering CBN add suffix "B" after GR# (Ex. GR1B-C for Borazon 80/100)



Order # for 80/100	Order # for 170/200	Diameter "MM"	Shank Diameter "MM"	Shank Length "MM"	Price for Diamond 80/100 or 170/200	Price for CBN 80/100 or 170/200
GR1-C	GR1-F	1	3	45	\$9.00	\$9.30
GR2-C	GR2-F	2	3	45	\$9.50	\$9.80
GR3-C	GR3-F	3	3	45	\$10.50	\$10.80
GR4-C	GR4-F	4	3	45	\$13.10	\$15.10
GR5-C	GR5-F	5	3	45	\$13.80	\$15.80
GR6-C	GR6-F	6	3	45	\$16.60	\$19.10
GR7-C	GR7-F	7	6	60	\$19.10	\$21.90
GR8-C	GR8-F	8	6	60	\$22.80	\$26.20
GR9-C	GR9-F	9	6	60	\$25.70	\$29.50
GR10-C	GR10-F	10	6	60	\$28.90	\$33.30
GR11-C	GR11-F	11	6	60	\$31.70	\$36.40
GR12-C	GR12-F	12	6	60	\$35.80	\$41.20

## TITAN DIAMOND and CBN RESIN MOUNTED WHEELS

**BOND USED IS A SPECIAL RESIN BOND THAT CAN BE TRUED AND GENERATED TO ANY SHAPE NECESSARY. BOTH DIAMOND AND CBN ARE 100 CONCENTRATION.**

( Prices are the same for Dimond or CBN or grit listed below please specify grit when ordering.)

14-21 Day Lead Time

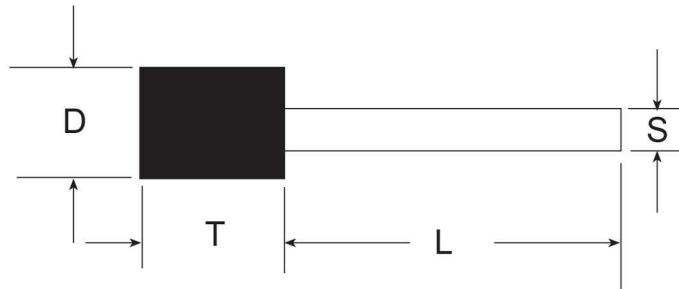

D	T	Y	L	Diamond		CBN		Pricing
				Coarse (120)	Medium (180)	Coarse (120)	Medium (220)	
0.125"	3/16"	1/8"	2"	DAC-101	DAM-101	CBC-101	CBM-101	\$54.50 Ea.
0.156"	3/16"	1/8"	2"	DAC-102	DAM-102	CBC-102	CBM-102	\$54.50 Ea.
0.187"	3/16"	1/8"	2"	DAC-103	DAM-103	CBC-103	CBM-103	\$54.50 Ea.
0.250"	1/4"	1/4"	2-3/4"	DAC-104	DAM-104	CBC-104	CBM-104	\$54.50 Ea.
0.312"	1/4"	1/4"	2-3/4"	DAC-105	DAM-105	CBC-105	CBM-105	\$54.50 Ea.
0.375"	1/4"	1/4"	2-3/4"	DAC-106	DAM-106	CBC-106	CBM-106	\$54.50 Ea.
0.437"	1/4"	1/4"	2-3/4"	DAC-107	DAM-107	CBC-107	CBM-107	\$58.20 Ea.
0.500"	1/4"	1/4"	2-3/4"	DAC-108	DAM-108	CBC-108	CBM-108	\$63.60 Ea.
0.625"	1/4"	3/8"	3-1/2"	DAC-109	DAM-109	CBC-109	CBM-109	\$92.70 Ea.
0.750"	1/4"	3/8"	3-1/2"	DAC-110	DAM-110	CBC-110	CBM-110	\$109.10 Ea.
1.000"	1/4"	3/8"	3-1/2"	DAC-111	DAM-111	CBC-111	CBM-111	\$174.50 Ea.